

ESTABLISHED COUNTY DRAINS

BURTCVILLE TOWNSHIP, T. 24 N. R. 16 E. ST. CLAIR COUNTY, MICH. SCALE - 1 1/2" = 2,000'

SANILAC CO.

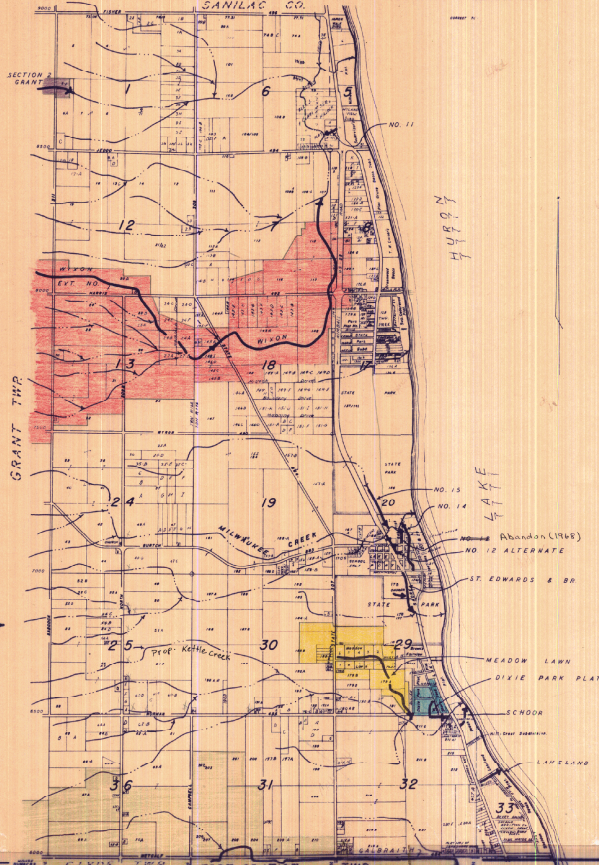

SECTION 2 GRANT

GRANT TWP

HUBBLE LAKE

LAKE

COUNTY DRAINS →
WATERCOURSE →

(A) (3)

DRAINS CORRECT TO B - 21

CLYDE TWP FORT GRATIOT TWP

BURTCVILLE TOWNSHIP